

## Equipment Description

### MAXPACK MFG-3 Horizontal Fill and Seal Machine For Premade Doypack

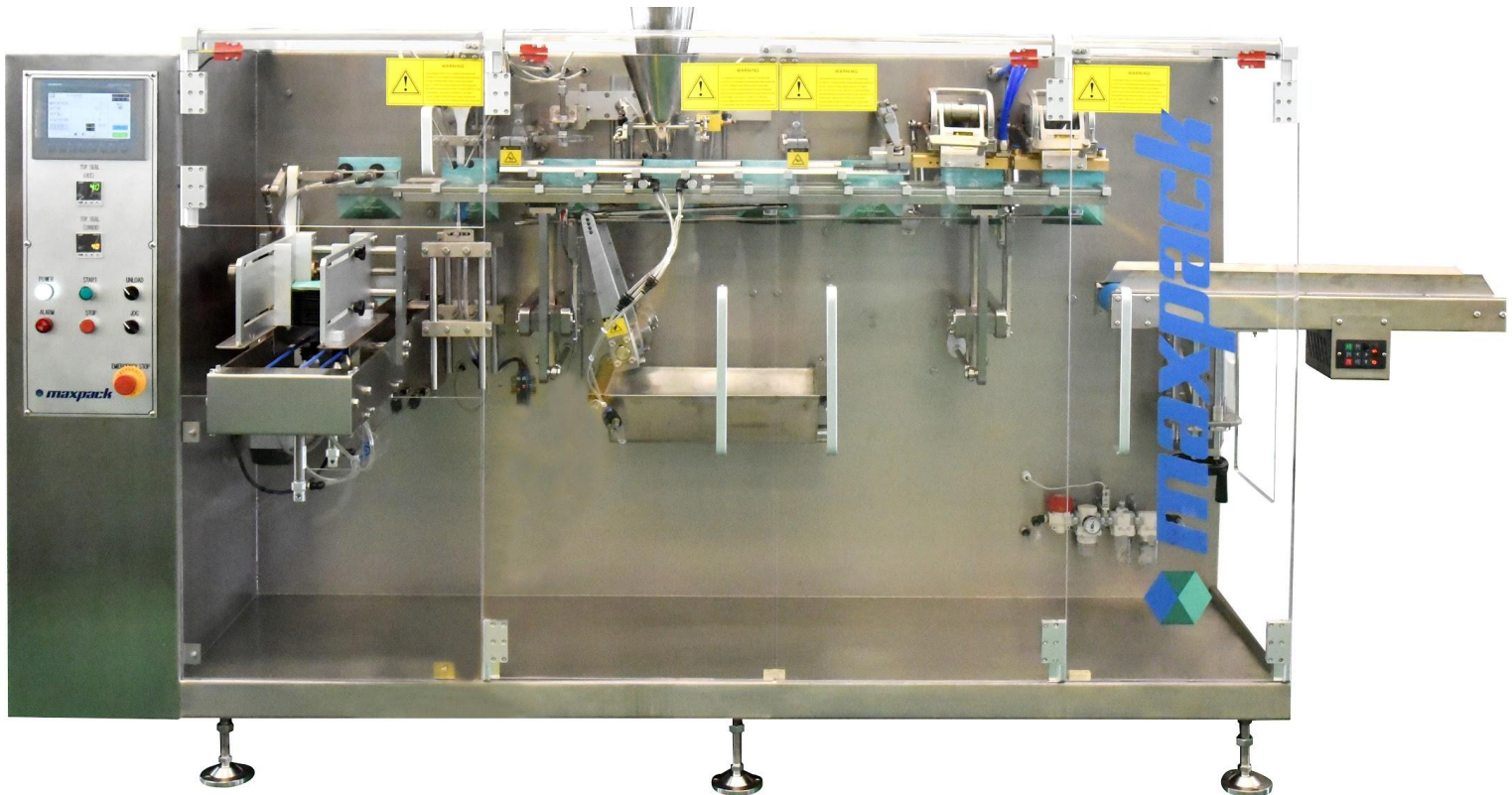

The MFG 3 Frozen&Ready is the 3rd generation of our stainless-steel, anti-rust, pre-made doypack machine. Built for the toughest environments; wet, frozen and humid, and to handle wet, sticky, hard to fill products, this machine was engineered for ready-to-eat and frozen food application

#### Premium Components

- SIEMENS S7-1200 PLC and KTP700
- No bag no fill function system
- Stainless steel 304# machine frame
- Bag in feed system for Doypack bags
- Schneider Electrical
- Omron Sensors
- Pneumatic SMC, Festo or Airtac
- Becker vacuum pump

#### Optionals features

- Auto lubrication system
- Ewon flexy remote access module
- Hanging hole perforation (Euro & Round)
- CIP cleaning tank connections
- Nitrogen gas flushing
- Nitrogen + Vacuum (max 5% O2)
- Bag shaker
- Third filling station for liquids

## Equipment Description

### MAXPACK MFG-3 Horizontal Fill and Seal Machine For Premade Doypack

#### Technical parameters:

<b>Pouch Width</b>	60 - 180 mm without Zipper 100 - 180mm with Zipper
<b>Pouch Height</b>	80 - 310 mm with/without zipper
<b>Speed</b>	Up to 50 pouches/min <sup>1</sup>
<b>Packaging Film</b>	Laminated film
<b>Product</b>	Powder / Granules / Solids/ Liquids
<b>Power consumption</b>	1.8 kW
<b>Power supply</b>	220V 60Hz 3 Ph
<b>Air Consumption</b>	0.2 m <sup>3</sup> /minute (7CFM)
<b>Air Pressure</b>	0.6 - 0.8 MPa (87 - 116 Psi)
<b>Weight</b>	700 kg
<b>Size (L×W×H)</b>	1990 mm × 970 mm × 1390 mm <sup>2</sup>

<sup>1</sup> Speed is estimated with empty bags, final speed depends on film material and product physical characteristics. Accuracy depends on filler type and final product characteristics

<sup>2</sup> Machine dimensions without any accessory add-on



## Equipment Description

MAXPACK MFG-3 Horizontal Fill and Seal Machine  
For Premade Doypack

### Packing photos



### Packing Pre made bags Samples:

3-Sides Flat Pouch	3 - 4 Sides Flat Pouch	Flat Pouch with Zipper
		
Standard Function	Standard Function	Standard Function
Stand-up Pouch (Doy Pack )	Pouch with Hanging Hole	Stand-up Pouch with Zipper
		
Standard Function	Optional Function	Standard Function

## Packing Process:

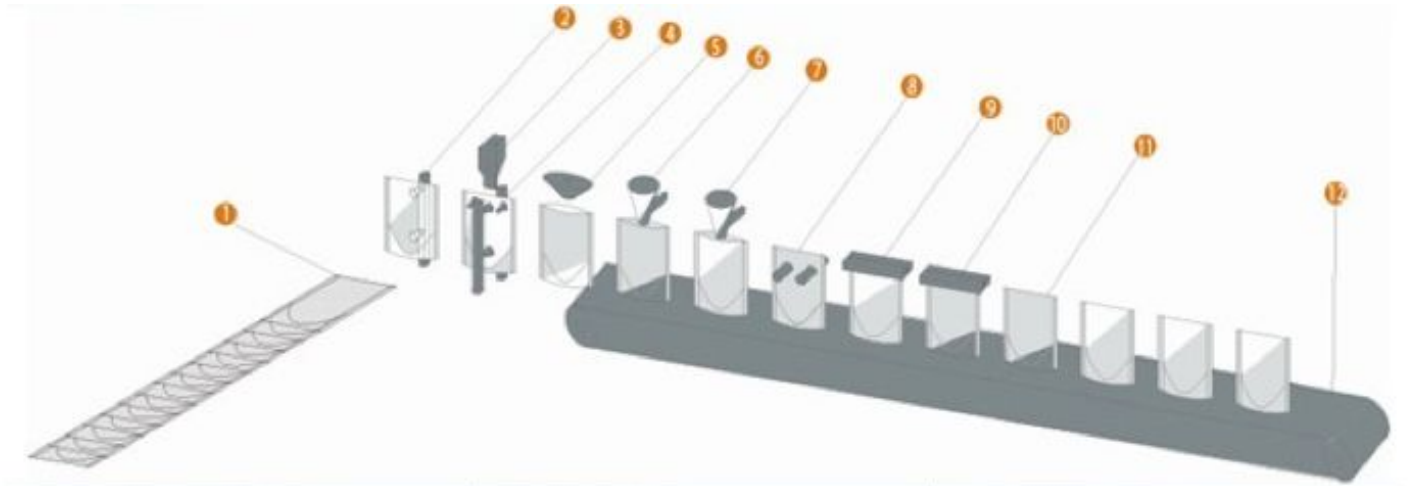

### Stations:

1. Pouch conveyor feeding
2. Pouch Pulling
3. Sensor
4. Pouch Opening
5. Gas flushing
6. Filling 1
7. Filling 2 or Spoon feed
8. Pouch closing
9. Top Seal
10. Cooling seal
11. Finished Product
12. Outlet



## Equipment Description

MAXPACK MFG-3 Horizontal Fill and Seal Machine  
For Premade Doypack

### Main Machine Electrical and Pneumatic Components

Main Components	Vendor
PLC	Siemens
Touch Screen	Siemens
Inverter	Schneider / Mitsubishi
Main Motor	ABB / Schneider
Pneumatic Parts	Festo / SMC / AIRTAC
Vacuum pump	Becker
Temperature Controller	Omron / Azbil

NOTE: Please specify if you require specific electrical and pneumatic components.  
If not, we will use our default suppliers.

**Please note that cost may change if specific suppliers are selected.**



## Walking Beam Structure

- Great position accuracy resulting in a more stable operation
- Built with rigid bearings required for packaging heavier formats
- Provides ease of accessibility for maintenance



**Machine Pictures:**

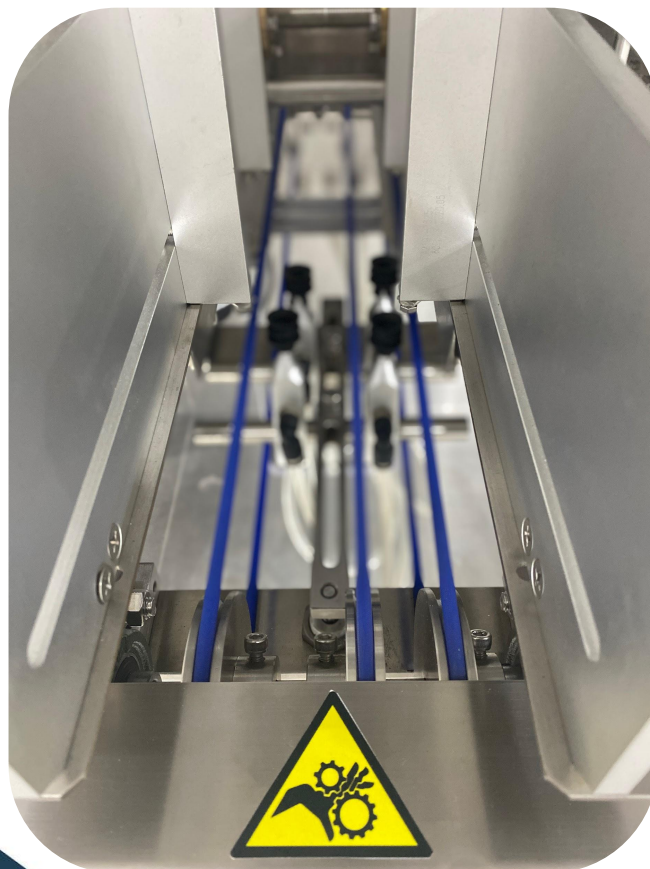

Machine Pictures:



Machine Pictures:

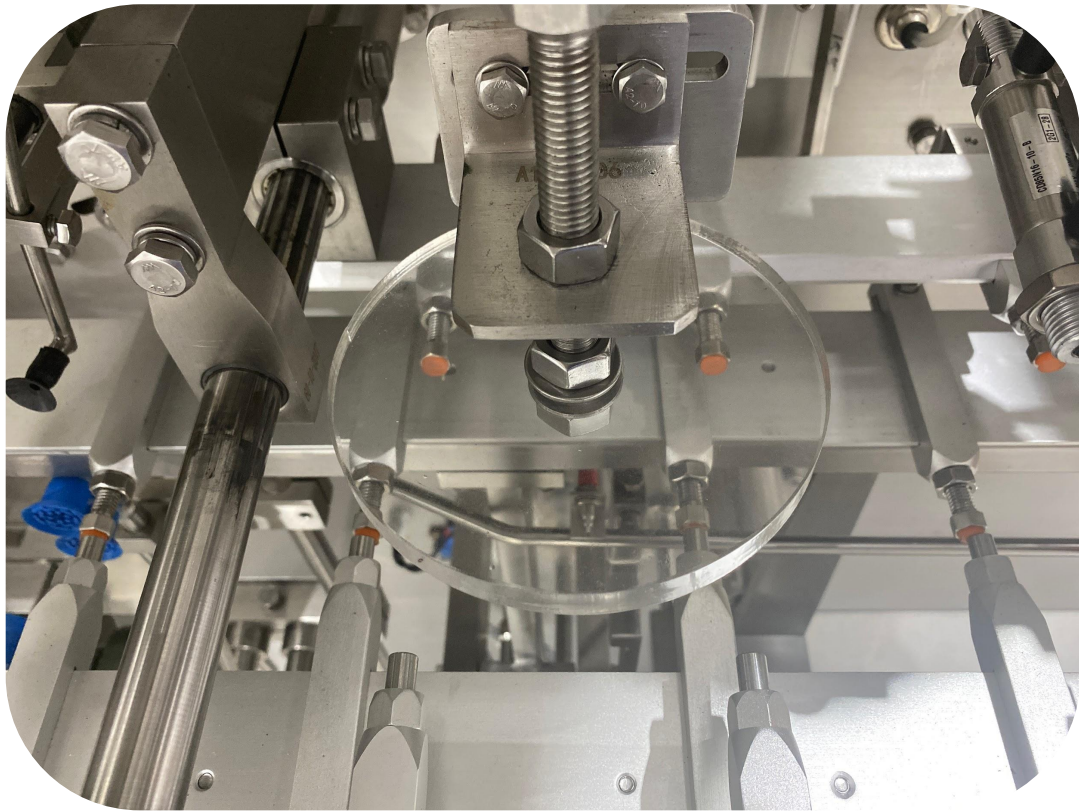

Machine Pictures:

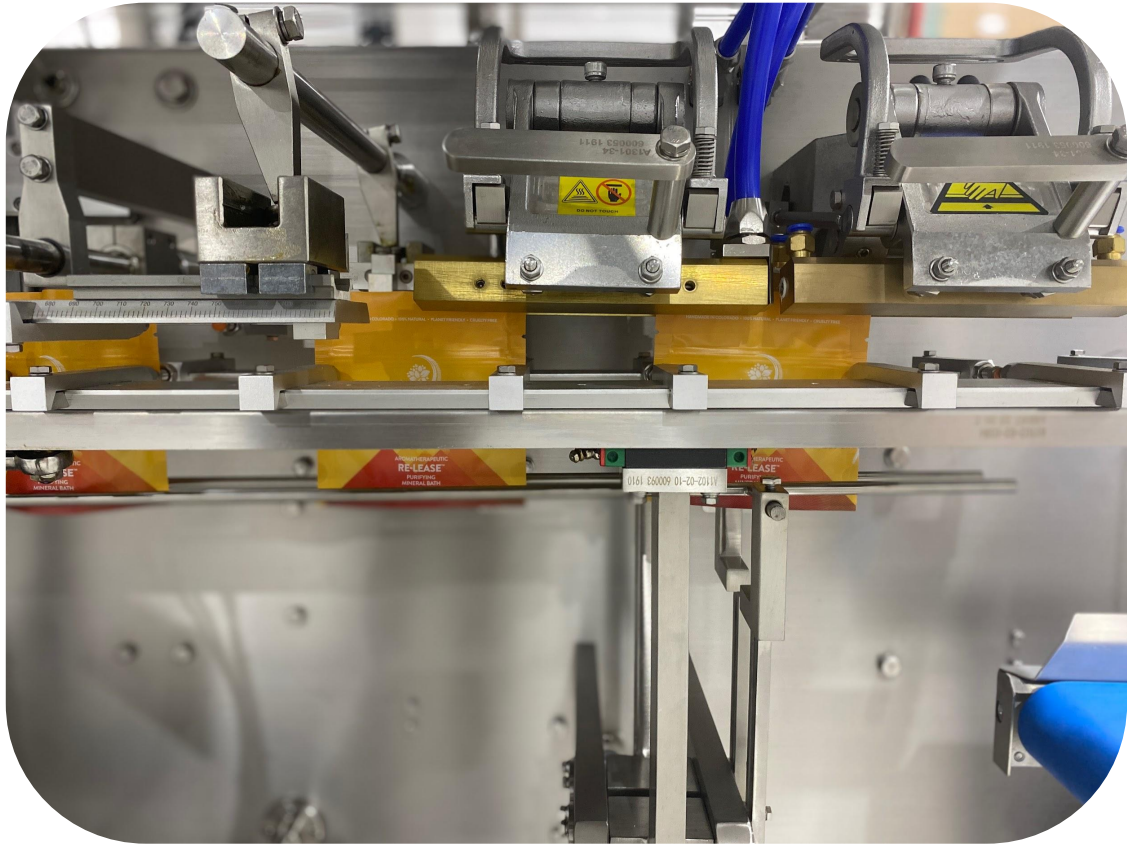

Machine Pictures:



Reference layout:

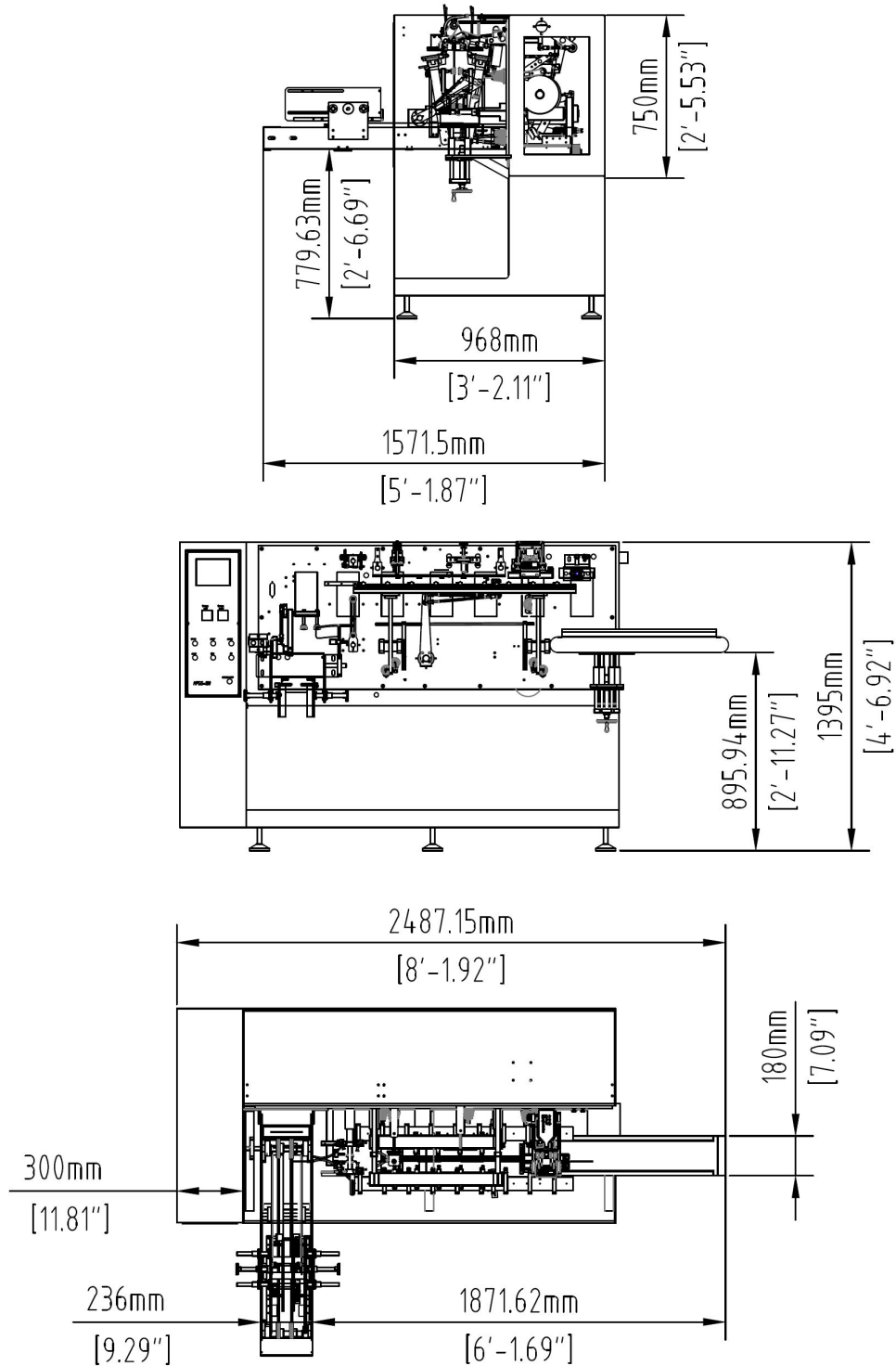

\*Measurements may change according to configurations and accessories.

*\*We reserve the right to make any changes in the design of the equipment, or internal components, without notice to the purchaser in order to guarantee industry standards.*



## Equipment Description

Multihead Scale 10-Head 2.5L



**SIEMENS**

Multi-head combination weigher is suitable for quantitative weighing of a large variety of solids including: granules, grains, salts, snacks, pet food, frozen and fresh foods, ready to eat products, among many others.

## Equipment Description

Multihead Scale 10-Head 2.5L

### **Function:**

- Equipped with 9" Colorful Siemens Touch Screen Control system with multiple languages integrated such as English and Spanish
- Wifi and cellular connection available for remote service (optional)
- The open angle of the hopper can be customized according to the product in order to accelerate the speed and improve the precision
- The combined hoppers can be preset to unload the material one by one so as to avoid the puffy material blocking at the hopper
- Provides options of rapid weighing mode & precise weighing mode to meet the needs of customers. It adopts high precision digital weighing sensor to ensure a precise weighing.
- Product level controlled by load cell instead of level sensor.
- IP65 waterproof and dustproof design.
- Machine with standard frame in SS AISI 304# or 316 as optional
- Self-checking and self-analyzing function helps to find and solve problems during operation
- It can record the total weight, total pouches, and qualified rate index for each operation due to the auto data statistic function
- The scale can either weigh or count according to target specifications
- **Accuracy between ranges of +/- 1%**



## Equipment Description

Multihead Scale 10-Head 2.5L

### Specifications:

<b>Range of SNGL WGT / Max. WGT</b>	<b>10 - 3.000g (Single Discharge)</b>
<b>AV SNGL Err / Range of WGT accuracy</b>	<b>0.1-1.5g</b>
<b>Max weighing speed</b>	<b>60 WPM <sup>1</sup></b>
<b>Volume of Weighing Bucket</b>	<b>2.5L</b>
<b>Driving</b>	<b>Step motor</b>
<b>Additional Features</b>	<b>Dimpled buckets / Rotary cone / Vibration cone</b>
<b>Control Panel</b>	<b>9" HMI touch panel Siemens TP900</b>
<b>Voltage/Power/Frequency/Rating Current</b>	<b>220V / 2KW / 60Hz / 12A</b>
<b>Machine Weight /total weight (kg)</b>	<b>400kg</b>
<b>Dimension / Packing Dimension (mm)</b>	<b>1620 (L) X 1100 (W) X 1110 (H)</b>

<sup>1</sup> Mechanical speed calculation is a reference guide and based on dry cycle, final speed and accuracy will be determined by the product physical characteristics and feeding.

*\*We reserve the right to make any changes in the design of the equipment, or internal components, without notice to the purchaser in order to guarantee industry standards.*

*Maxpack engineers will apply the additional features according to the product and client requirements*



## Equipment Description

Multihead Scale 10-Head 2.5L



## Equipment Description

Multihead Scale 10-Head 2.5L

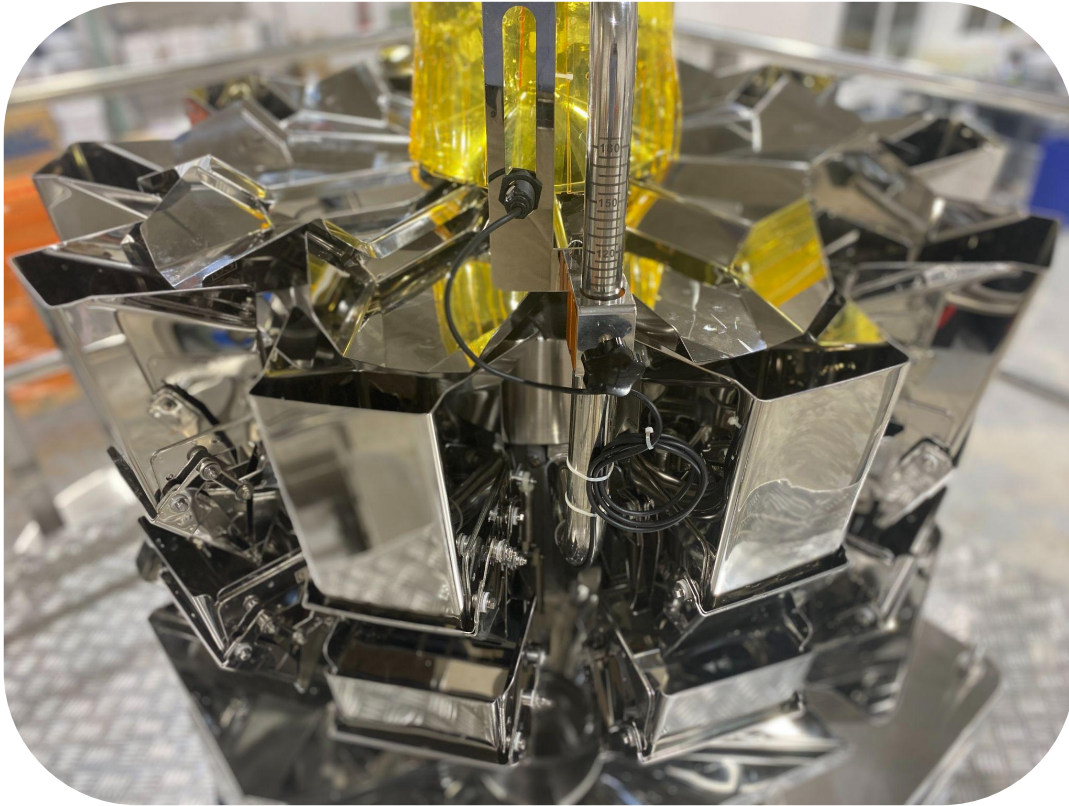

## Equipment Description

Multihead Scale 10-Head 2.5L

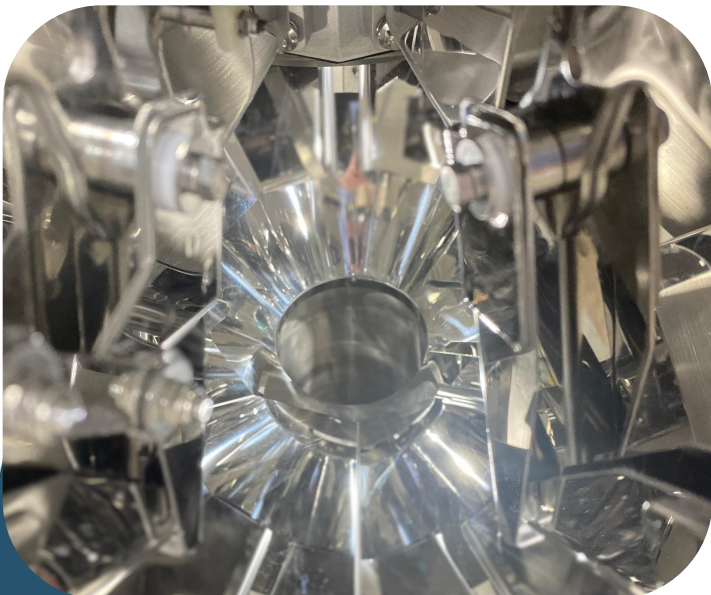
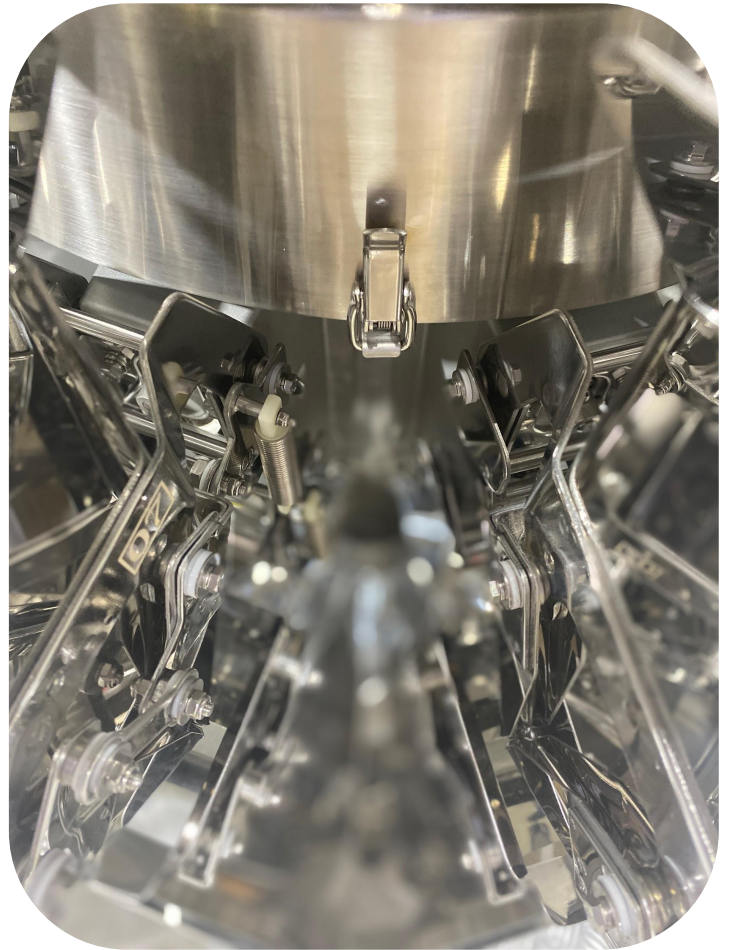
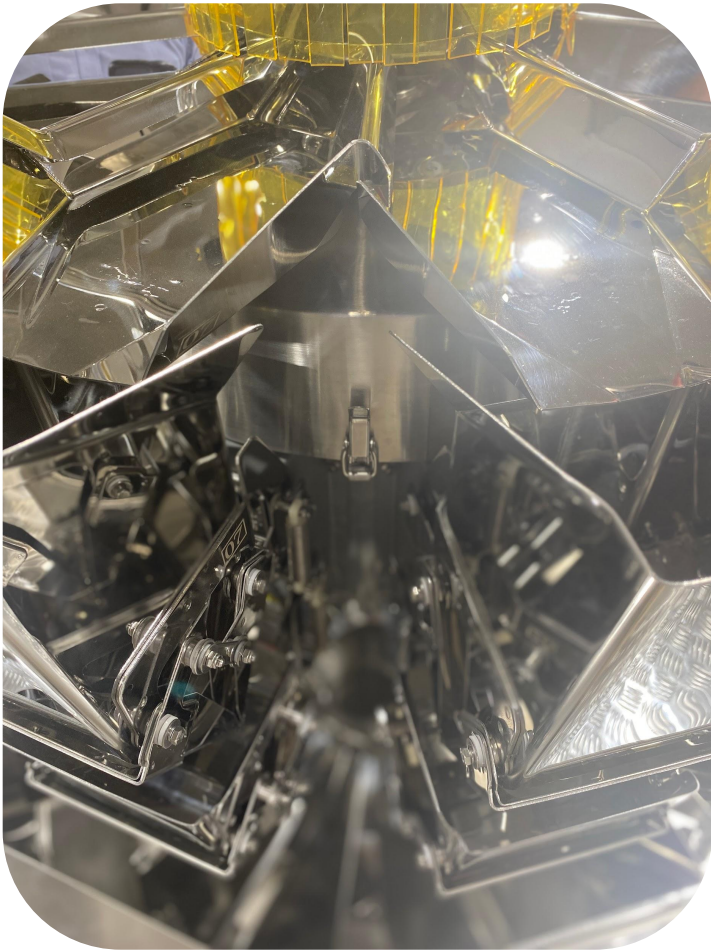

## Equipment Description

### Multihead Scale 10-Head 2.5L

#### Reference layout:

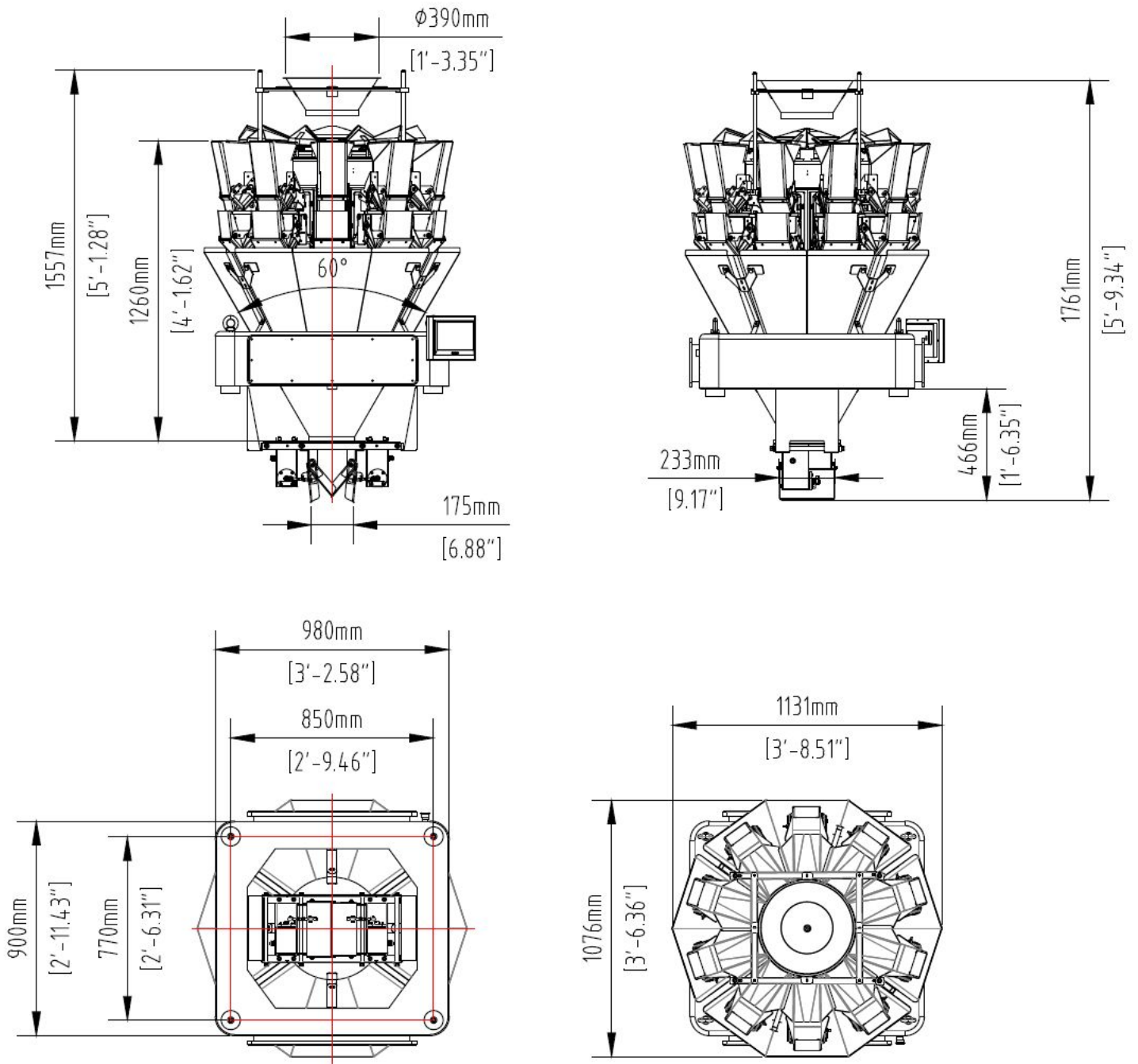

\*Measurements may change according to configurations and accessories.

\*We reserve the right to make any changes in the design of the equipment, or internal components, without notice to the purchaser in order to guarantee industry standards.

## Equipment Description

MAXPACK Standard Z Shape Bucket Conveyor with Vibration Feeder

## Optional equipment

### Introduction

The Standard Z Shape Bucket product Conveyor can handle a wide variety of products without degradation. Its function is to elevate the materials from the ground to the multihead scale.

Includes vibration hopper and multi door access with clear panel for fast cleaning

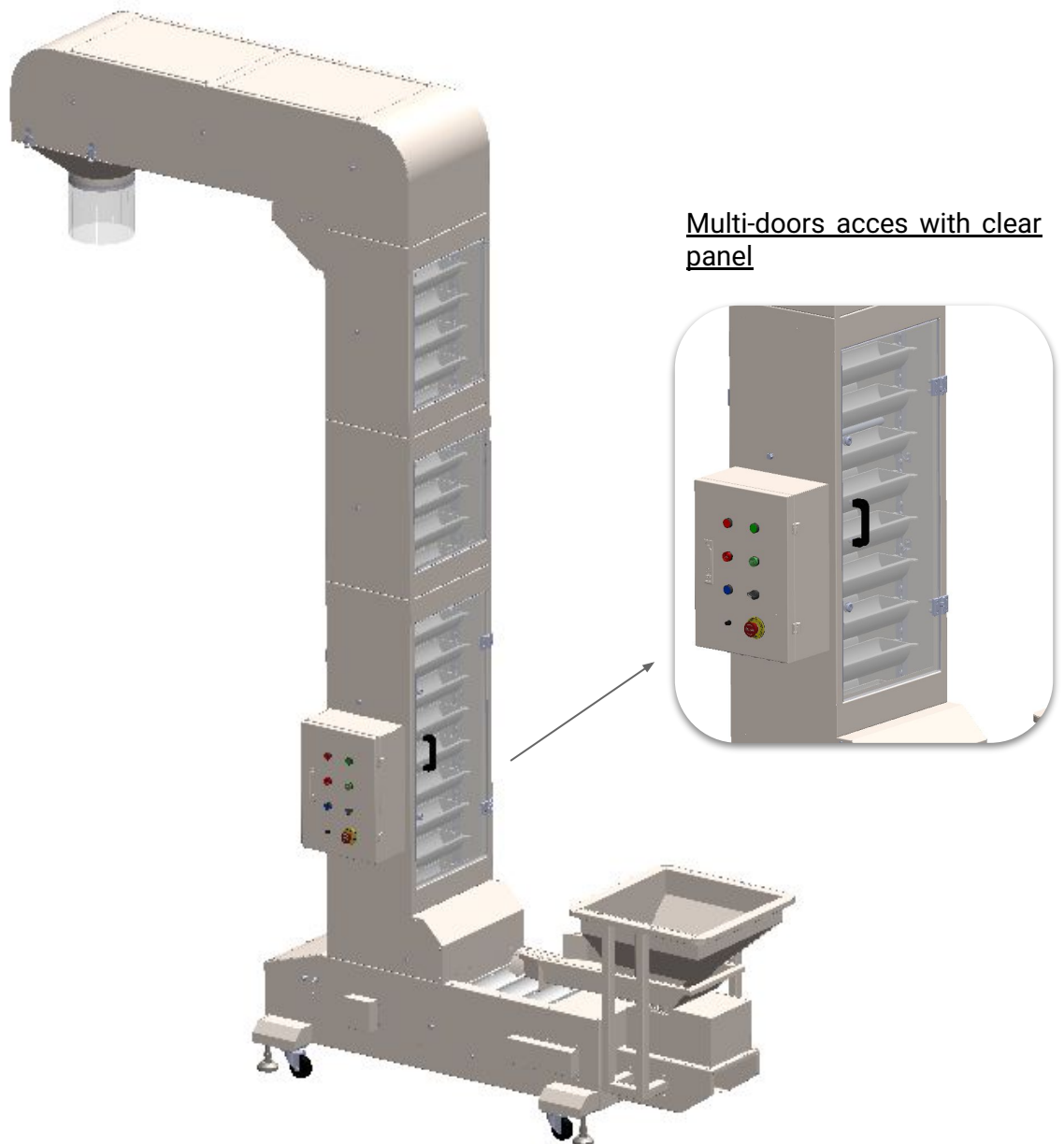

## Equipment Description

MAXPACK Standard Z Shape Bucket Conveyor with Vibration Feeder

## Optional equipment

### Technical Characteristics

- Applicable for vertical feeding of granule or small block material
- All products contact-parts are food-grade ABS buckets for sanitary usage.
- Speed is adjusted by Frequency Converter
- Adjustable feeding vibrator rates for various flowing suitable products
- With automatic chain tension device and built-in overload protection
- Material-Level sensor to activate automatically when integrated with other machines.
- Quick-release mechanism to facilitate the fast installation or removal.
- Easy access for cleaning with multi door
- SS AISI 304# frame
- SS AISI 304# chain, shaft and gears.
- Customized-discharge height designs.

Food-grade ABS buckets

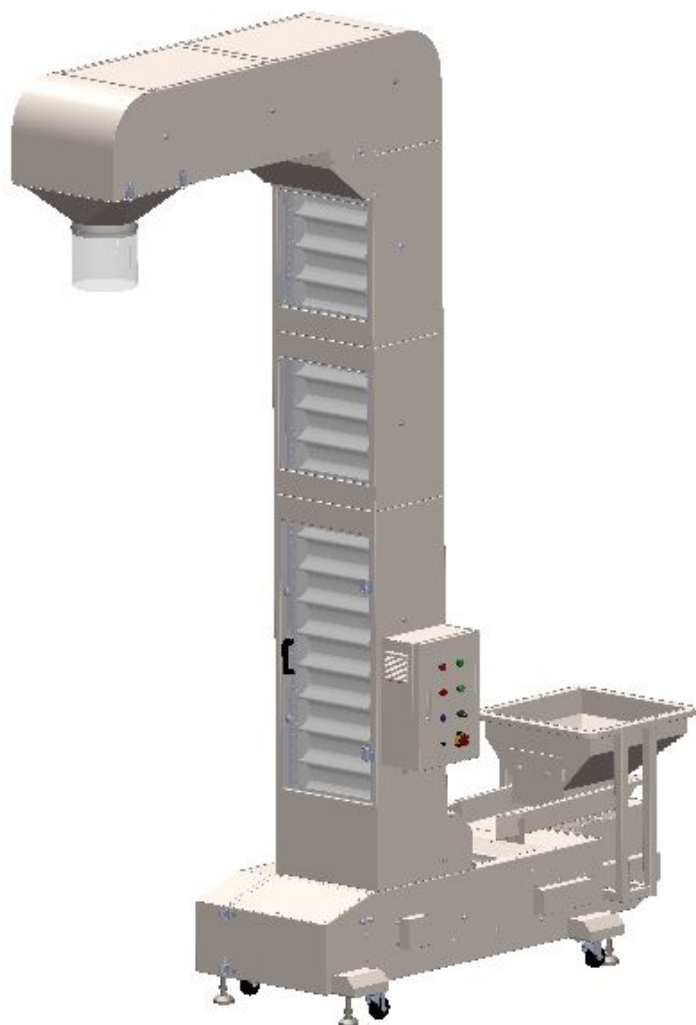
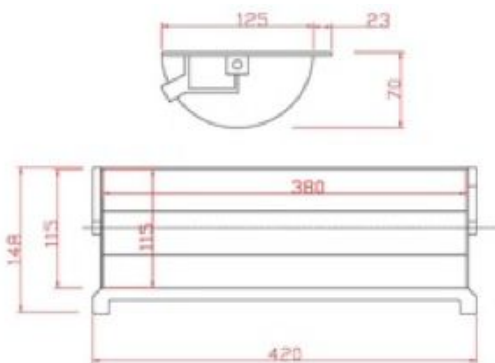

## Equipment Description

MAXPACK Standard Z Shape Bucket Conveyor with Vibration Feeder

### Specification:

<b>Discharge height</b>	<b>2-6 m (Able to be customized refer to the requirements)</b>
<b>Power</b>	<b>1.5KW 10A</b>
<b>Capacity</b>	<b>2.5~5 CBM/hr</b>
<b>Electric Supply</b>	<b>220V/60Hz, 1PH or 3PH</b>
<b>Conveyor Frame</b>	<b>Full SS AISI 304# frame</b>



Reference layout:

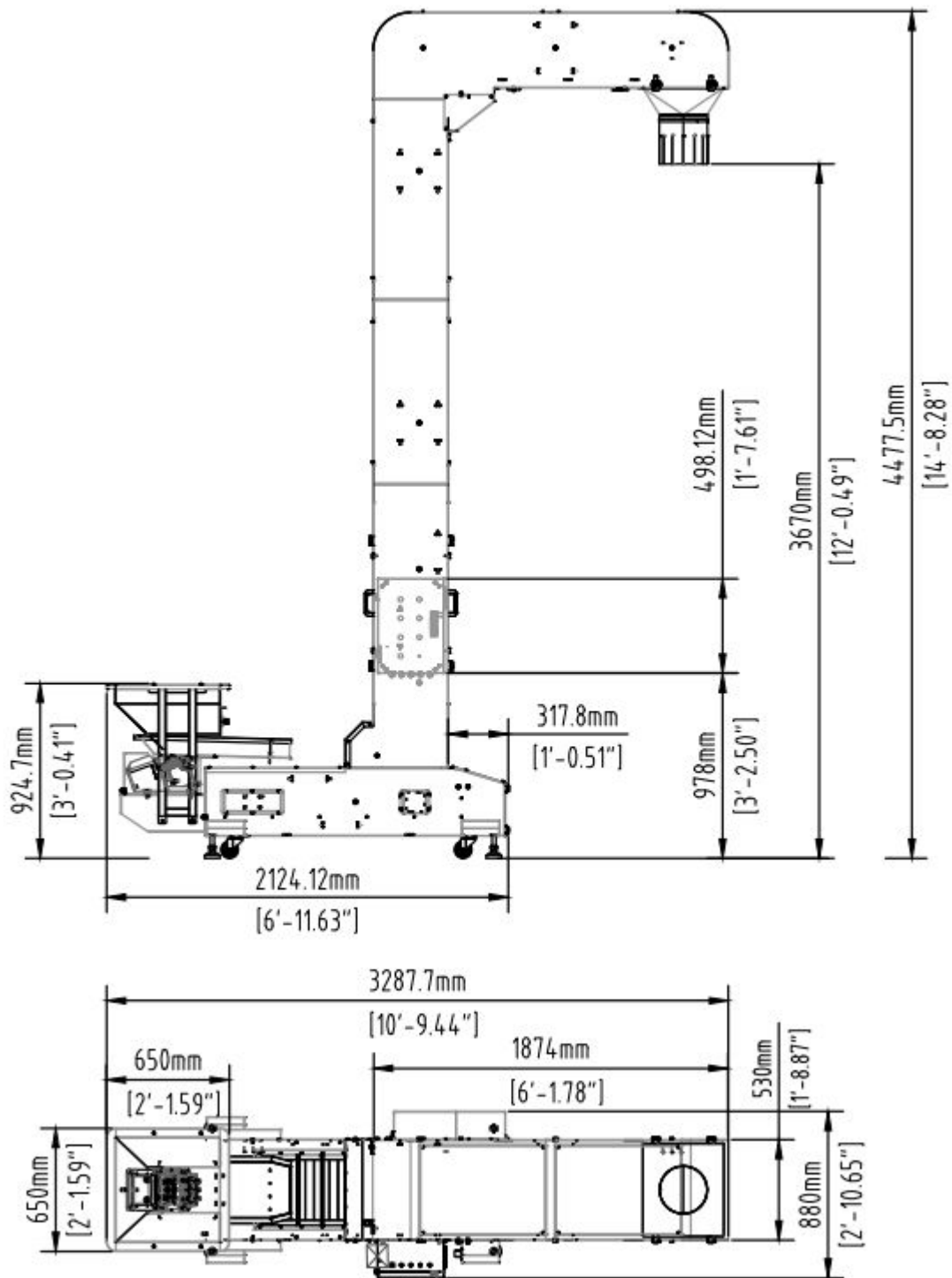

\*Measurements may change according to configurations and accessories.

*\*We reserve the right to make any changes in the design of the equipment, or internal components, without notice to the purchaser in order to guarantee industry standards.*



## Equipment Description



### **Maxpack RT-1200 Rotary Table**

All the finished small packages could be delivered to the rotary accumulation table. Its diameter is able to be customized. Speed is adjustable if ordered with frequency converter.

<b>Capacity</b>	<b>9 RPM</b>
<b>Power</b>	<b>370 W</b>
<b>Table diameter</b>	<b>1200 mm or customized</b>
<b>Power Supply</b>	<b>220V/60Hz, 1 Ph</b>
<b>Weight</b>	<b>70 kg</b>

*\*We reserve the right to make any changes in the design of the equipment, or internal components, without notice to the purchaser in order to guarantee industry standards.*

Reference layout:

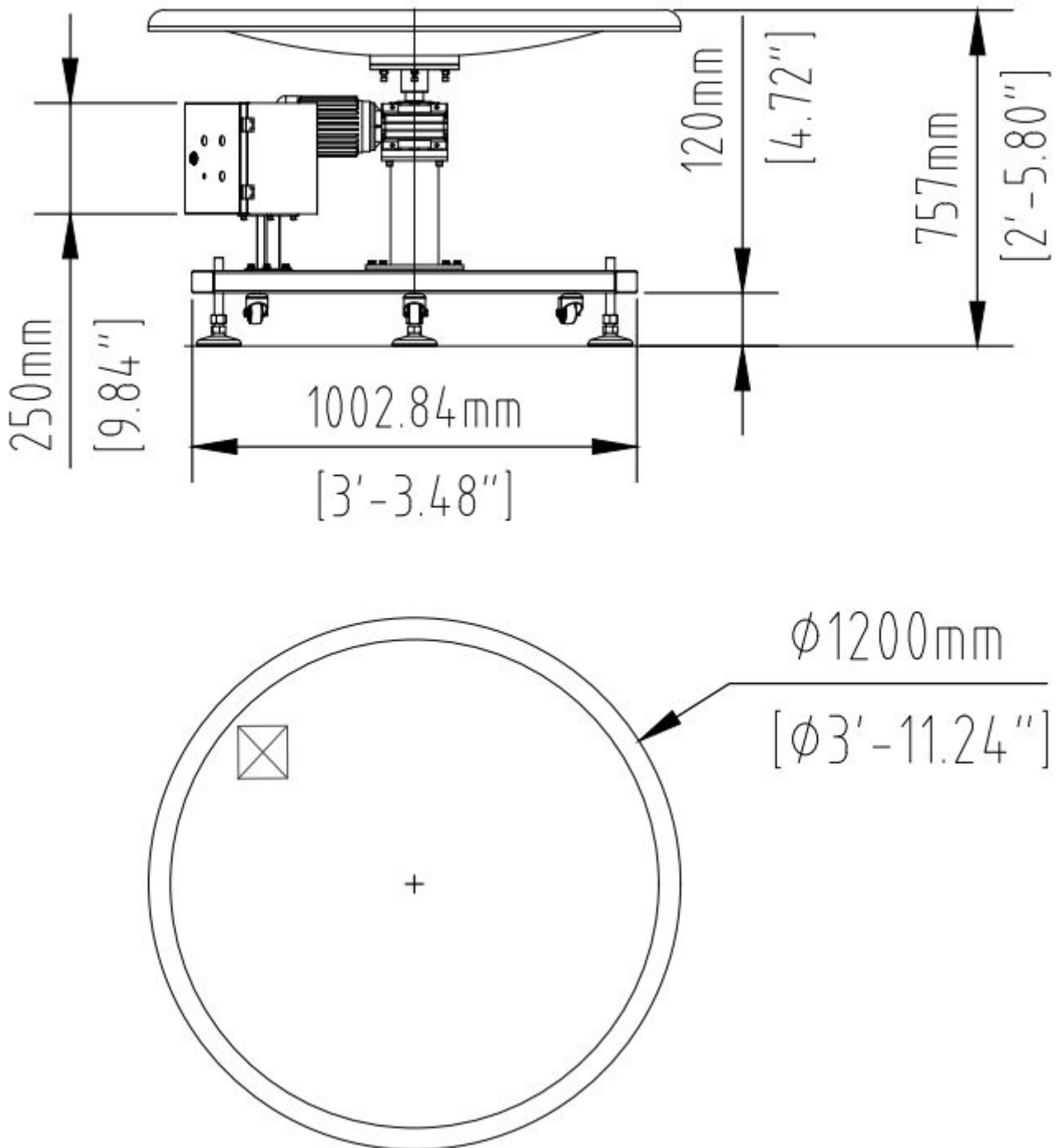

\*Measurements may change according to configurations and accessories.

*\*We reserve the right to make any changes in the design of the equipment, or internal components, without notice to the purchaser in order to guarantee industry standards.*

